



**push-in fittings for telecom microducts**

**@NET.Fit<sup>®</sup>**  
Evolution

---

 **NET.Fit<sup>®</sup>**

# @NET.Fit<sup>®</sup> Datasheet

Evolution

Evolution NET.Fit fittings and accessories have been studied by Tierre Group in order to be used for FTTH applications. Evolution NET.Fit is in compliance with the IEC 61753-1, EN 50411-2-8 and RoHS 2. Evolution NET.Fit products have been tested in order to simulate a 20 years lifetime.

## System Benefits

- **Fully Plastic Solution.**
- **Pre-installed tamper-proof reusable locking clip** system in order to prevent microducts accidental disconnection.
- Fully transparent (clear) body for perfect visual inspection for correct tube & fibres insertion.
- Union connectors with the internal shape designed in order NOT to be affected by the internal diameter of the duct.
- Dark Rubber Cover available in order to prevent damages. Its special design allow inspection of correct installation of the cable also when installed.
- UV resistant if installed with dark rubber cover mounted.
- Easy connection & disconnection of the duct due to the smart gripping system studied for pneumatic heavy applications.
- Studied in order to be suitable for direct buried application when installed with dark rubber cover mounted.

## Technical Specifications

### Materials

- **Body:** Transparent PA
- **Cartridge:** Black POM
- **Support ring:** Orange POM
- **Collet:** Black POM
- **Seal:** NBR suitable for gas
- **Lock Claw:** Stainless Steel
- **Tamper-Proof Locking Clip:** Orange POM
- **Rubber Cover:** Dark Silicon

## Performances

### Temperatures:

- Minimum working temperature: -20°C
- Maximum working temperature: +50°C

### Pressure:

- Working pressure: 15 bar
- Short term blowing pressure (10'): 25 bar
- Burst pressure (all diameters): accordingly to EN50411-2-8

### Lifetime Simulation:

NET.Fit fittings have been tested in order to simulate a 20 years lifetime. The simulation includes tests at extreme temperatures (-40°C +65°C) and working pressure at 35 bar, salt mist test and test with the most common solvents and contaminating fluids. Test reports available on demand.

# @NET.Fit<sup>®</sup> products

Evolution

## EFXUC

### UNION CONNECTOR



CODE	ØD (mm)	ØA (mm)	L (mm)
EFXUC03	3	14,8	33,0
EFXUC05	5	16,8	35,2
EFXUC07	7	18,8	39,1
EFXUC10	10	22,2	46,4
EFXUC12	12	25,0	49,2
EFXUC14	14	26,7	50,2

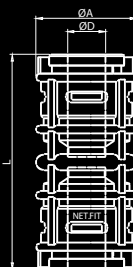

## EFXPF

### FEMALE PLUG



CODE	ØD (mm)	ØA (mm)	L (mm)
EFXPF12	12	25,0	26,3
EFXPF14	14	26,7	27,0

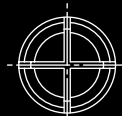
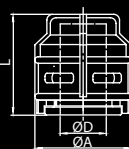



# eNET.Fit<sup>®</sup> products

Evolution

## EFXRC

### RUBBER COVER



CODE	ØA (mm)	ØB (mm)	ØC (mm)	ØD (mm)	L (mm)	L1 (mm)
EFXRC03	14,3	18,3	6,1	3,0	22,6	18,1
EFXRC05	16,3	20,3	8,1	5,0	25,7	19,2
EFXRC07	18,3	22,3	10,1	7,0	29,6	21,1
EFXRC10	21,7	25,7	13,1	10,0	35,3	24,8
EFXRC12	24,5	28,5	15,1	12,0	38,7	26,2
EFXRC14	26,2	30,2	17,1	14,0	41,2	26,7

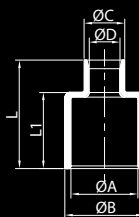

### DIMENSIONS FOR UNION CONNECTOR WITH DARK RUBBER COVER



CODE	ØD (mm)	ØA (mm)	ØB (mm)	L1 (mm)	L2 (mm)
EFXUC03	3	6,1	18,3	36,2	45,2
EFXUC05	5	8,1	20,3	38,4	51,4
EFXUC07	7	10,1	22,3	42,2	59,2
EFXUC10	10	13,1	25,7	49,6	70,6
EFXUC12	12	15,1	28,5	52,4	77,4
EFXUC14	14	17,1	30,2	53,4	82,4

